

California Lutheran University (CLU) offers over 36 majors and 28 minors, in addition to professional preparation programs in specified fields of study. Various popular Masters degree programs are available as well as credentials programs and certificates. CLU is ranked as one of the top 20 "Masters Universities of the West" by US News & World Report.

A sample of some of the majors include:

### Undergraduate Majors:

Accounting (BS)  
Art (BA)  
Biochemistry and Molecular Biology (BA & BS)  
Bioengineering (BS)  
Biological Sciences (BA & BS)  
Business Administration (BS)  
Chemistry (BA & BS)  
Communications (BA)  
Computer Information Systems (BS)  
Computer Science (BS)  
Criminal Justice (BS)  
Economics (BA)  
Education/Liberal Studies (BA)  
English (BA)  
Environmental Science (BS)  
Exercise Science & Sports Medicine (BS)  
History (BA)  
International Studies (BA)  
Marketing Communication (BA)  
Mathematics (BA & BS)  
Multimedia (BA)  
Music (BA)  
Physics (BA & BS)  
Philosophy (BA)  
Political Science (BA)  
Psychology (BA & BS)  
Sociology (BA)  
Theatre Arts (BA)

### Graduate Programs:

International MBA – one year program  
Master of Business Administration (MBA)  
Master of Education  
Master of Public Policy and Administration  
MS in Clinical Psychology  
MS in Computer Science

visit [www.callutheran.edu](http://www.callutheran.edu) to learn more



### California Lutheran University offers the following advantages to ELS students:

- Acceptance of ELS Level 112 (Intensive English program) in place of the TOEFL® requirement.
- Conditional acceptance to qualified students for both undergraduate and graduate programs.
- Over 36 majors and various popular Masters degree programs, including a one-year International MBA program.
- Concurrent Enrollment at CLU while studying in the ELS Intensive English Program (for conditionally accepted students)



Study English | Explore | Succeed

## Study English at California Lutheran University with ELS Language Centers!



[www.els.edu/thousandocks](http://www.els.edu/thousandocks)



## Study English at ELS Language Centers in Thousand Oaks, CA

ELS Language Centers has been preparing students for university study in the USA by teaching them English for over 45 years. ELS Language Centers is happy to partner with California Lutheran University (CLU) to help you meet your English study goals.

ELS offers students the following English programs:

### Intensive English Program

Fulfills the English language requirement for admission at over 550 US universities and colleges, including California Lutheran University. 30 lessons per week.

### Semi-Intensive English Program

Learn English at a leisurely pace. 20 lessons per week.

### American Explorer Program

Designed for tourists who would like part-time English study. 15 lessons per week.

### Program features:

- 12 levels of instruction from Beginning to Masters levels
- Classes Monday to Friday
- 4-week sessions (Intensive & Semi-Intensive English program sessions the equivalent of one ELS proficiency level)
- 13 start dates annually

Learn more about our English programs at [www.els.edu/programs](http://www.els.edu/programs)

STUDY ENGLISH | EXPLORE | SUCCEED

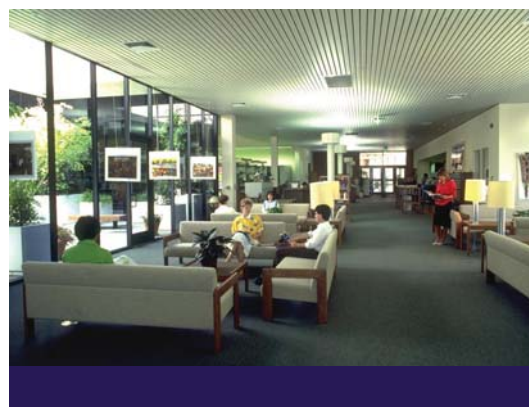
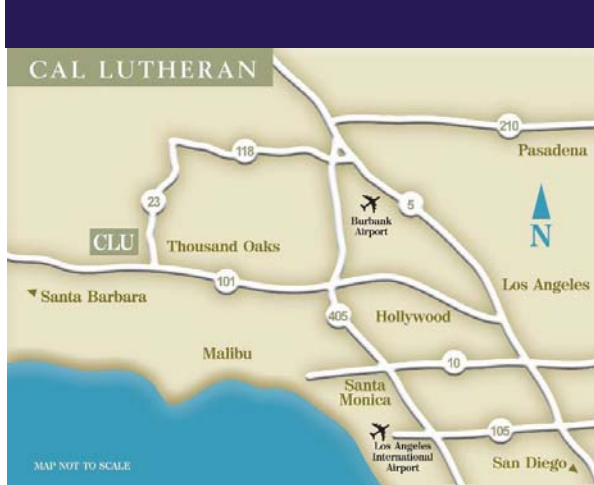

## Choose ELS Language Centers!

**Experience:** For over 45 years ELS Language Centers (ELS) has helped hundreds of thousands of students from over 140 countries around the world learn English.

**Location:** ELS Language Centers is located on the beautiful and safe 90-hectare campus of California Lutheran University, in Thousand Oaks, California. Located mid-way between Los Angeles and Santa Barbara and with easy access to both, Thousand Oaks is also located just 19 km from the beautiful Pacific coast and beaches.

**Housing:** Year-round ELS students can choose to live with an American family in the local area or in a shared off-campus apartment (double and triple rooms). During the summer an on campus dormitory will also be available.

**Facility Use:** California Lutheran University will offer ELS students use of many recreational facilities (e.g. cafeteria, outdoor swimming pool, gymnasium, state of the art fitness center, sports fields, tennis courts and library).

**Activities:** ELS plans a wide range of activities for students, from sightseeing to visits to local attractions, center parties, and more.

**ELS Language Centers**  
at **California Lutheran University**  
203 Faculty Street (Mattson House)  
Thousand Oaks, CA 91360 USA  
Tel: +1.805.493.3760  
[www.els.edu/thousandoaks](http://www.els.edu/thousandoaks)  
[tho@els.edu](mailto:tho@els.edu)